

Bravo

Exhaust fans

Features



- Wall and ceiling mounting
- Low noise impeller
- Easy maintenance
- Continuous operation
- Backdraft damper
- Ball bearing motor
- 5 year warranty



Air flow:
up to 305 m³/h
85 l/s



Power:
from 14 W

SFP:
from 0.28 W/l/s



Noise level:
from 35 dBA



IP34



Overall Dimensions and Mounting

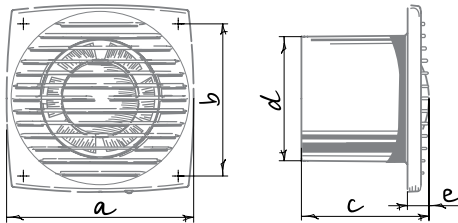

Dimensions [mm]	a	b	c	∅ d	e
Bravo 100	150	122	102	100	17
Bravo 125	176	144	104	125	17
Bravo 150	205	174	124	150	19

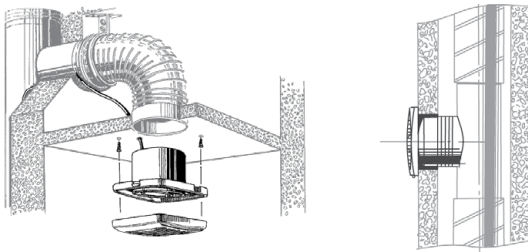

Technical Data

Model	Bravo 100	Bravo 125	Bravo 150
Voltage [V/Hz]	220-240/50	220-240/50	220-240/50
Power [W]	14	16	24
Current [A]	0.085	0.1	0.13
RPM [min ⁻¹]	2300	2400	2400
Air flow [m ³ /h (l/s)]	101 (28)	192 (53)	305 (85)
SFP [W/l/s]	0.5	0.3	0.28
Noise level [dBA]	35	37	39

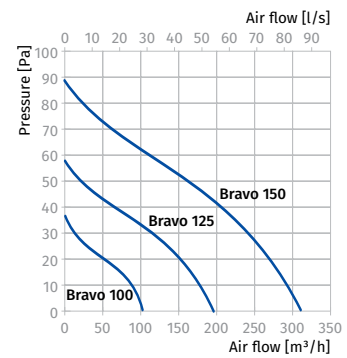

Ordering Information

Part Number	Model	Description
BLABBRAVO100	Bravo 100	WALL/CEILING FAN 100 mm
BLABBRAVO125	Bravo 125	WALL/CEILING FAN 125 mm
BLABBRAVO150	Bravo 150	WALL/CEILING FAN 150 mm

Accessories

Flexible air ducts



Grilles and cowls

